

# Annexure 1: Schematic

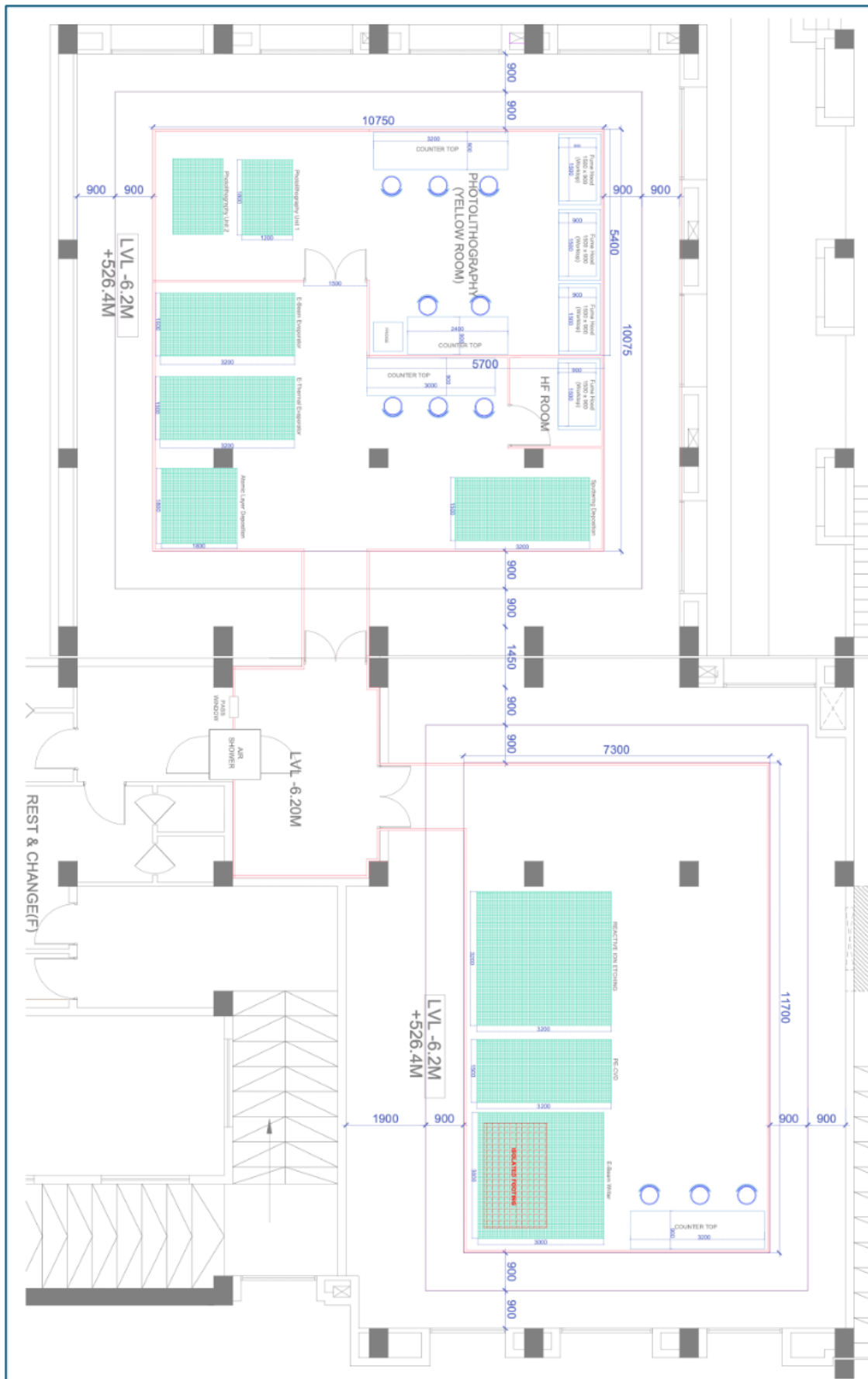

## Annexure 2: Usage Data Matrix

Sl No	Equipment/Tools	Height of false ceiling from FFL in FEET	Height of TRUE ceiling from FFL in FEET	Area in Sqft	Connected Power in KW per Machine	Number of Machines	Total kW for all the machines	Occupancy (max)	Process Extraction in CFM	Temp °C +/- 2 °C	RH (%) +/- (%) 5	Lighting in Lux	Type of Flooring	
<b>A. PHOTOLITHO LAB</b>														
1	Micro Writer x 2	3 m	5.5 m	511	3.7	2	7.4	6		22	45	550 nm (yellow)	ESD	
2	Microscope				1.4	1	1.4							
3	Spin coater x 2				1.4	2	2.8							
4	Hotplate x 4				1.4	4	5.6							
5	Plasma asher				3.7	1	3.7							
6	Hood x3				7.4	3	22.2							
SUB TOTAL 1							43.1	6	400 cfm					
<b>B. DIFFUSION LAB</b>														
1	E-beam Evaporation	3 m	5.5 m	570	25	1	25	6		22	50	450 -500 lux white	ESD	
2	Thermal Evaporator				12	1	12							
3	Atomic Layer Deposition (ALD)				8.8	1	8.8							
4	Sputtering Deposition				3.1	1	3.1							
5	Microscope				1.4	1	1.4							
6	Profilometer				1.0	1	1							
7	Ellipsometer				3.5	1	3.5							
8	Rapid Thermal Annealing				8.5	1	8.5							
SUB TOTAL 2							63.3	6						
<b>C. HF LAB</b>														
1	1 Hood	3 m	5.5 m	50	7.4	1	7.4	2	400 cfm	22	50	450-500 Lux white	ESD	
2	1 Shower				0	1	0							
SUB TOTAL 3							7.4	2						
<b>D. PACKAGING &amp; LITHO</b>														
1	E-Beam Writer	3 m	5.5 m	894	8.8	1	8.8	6		22	50	450-500 lux white	ESD	
2	RIE				8.8	1	8.8		10 cfm					
3	PE-CVD				25	1	25							
4	Wafer Dicing				7.4	2	14.8		NO					
5	Wire bonder				1.3	2	2.6							
6	Counter top tables for further expansion				0	1	0							
SUB TOTAL 4						0	60	6						
<b>E. AIR LOCK</b>														
1	Air SHOWER						3	6		22	50	450-500 lux white	ESD	
SUB TOTAL 5				258			3	6						
<b>F. GOWNING</b>														
1	Garment Cubicles						3	15						ESD
SUB TOTAL 6				109			3	15						
Cleanroom Total				2392			180	41						
<b>G. Utility Corridor -01</b>														
SUB TOTAL -7				1012			5	3		23	55		Epoxy	
<b>H. Utility Corridor -02</b>														
SUB TOTAL -8				1014			5	3		23	55		Epoxy	
GRAND TOTAL				4418			190	47						